

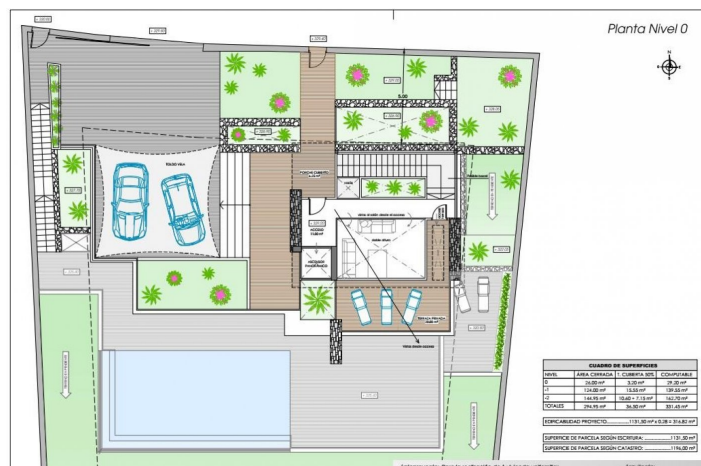

115.000 €

Referentie: RS17030 Plotgrootte: 1.132m²





Costa Blanca North, Altea

It is a south facing plot with incredible views in Altea Hills. In its western boundary there is a plot of Green Zone owned by the City Council of Altea and there are also no urban plots above it since it is rustic land. Its surface is 1,131.50m² although in cadastre it appears a little more 1,196m². On the plot you can build an isolated detached house with the following characteristics:

- Maximum occupancy: 33%
- Maximum buildable: 28%
- Maximum height: 7m (2 floors)

- Retranqueos: 5 m to the street and 3 m to neighbors

The sale price does not include expenses or taxes